

Middleton Avenue

Hove



We know just the place...



Boasting in excess of 2,200 square feet this family home really does tick all the boxes.

Located on a quiet leafy street and moments from the sea, this semi detached home has been beautifully renovated by the current owners.

The entrance to the property is both warm and inviting. The ground floor comprises a lovely bright reception room with oak flooring, open fire place and plantation shutters. This is a quiet retreat from the hub of the home which is the fantastically appointed kitchen/lounge/family room. This space really does have the wow factor and has been extended and designed to exacting standards with quality at the forefront of everything. The Harvey Jones kitchen with solid oak shaker style units oozes style and elegance. Features include caesar stone worktops, underfloor heating, wine cooler, LG fridge and a quooker boiling water tap. From here, bifold doors lead out onto an idyllic low maintenance west facing garden. A perfect spot for an evening g&t! There is also a nice sized utility and separate shower room on this level.

The first floor has three double bedrooms and a single which is currently configured as a dressing room, and a luxury family bathroom. The second floor has been converted into a lovely bright studio and work space but is also perfect for a bedroom.

Middleton Avenue runs between New Church Road and the seafront in Hove. Local shopping facilities exist nearby as do bus services that afford access to many other parts of the City including the outlying villages. Amenities are within a short distance including the seafront/Hove lagoon, Hove and Portslade mainline railway stations. The house is also well-positioned in terms of schools making it an ideal family home.

This is a great home. In short: a must see!









What the owner says...

What the Owner Says



"I have loved living here. The road is so quiet. The neighbours are great and there is a real community spirit and we have an annual street party . The location is great and the beach is a hop, skip and a jump away! This has been a wonderful family home and I will miss it greatly."

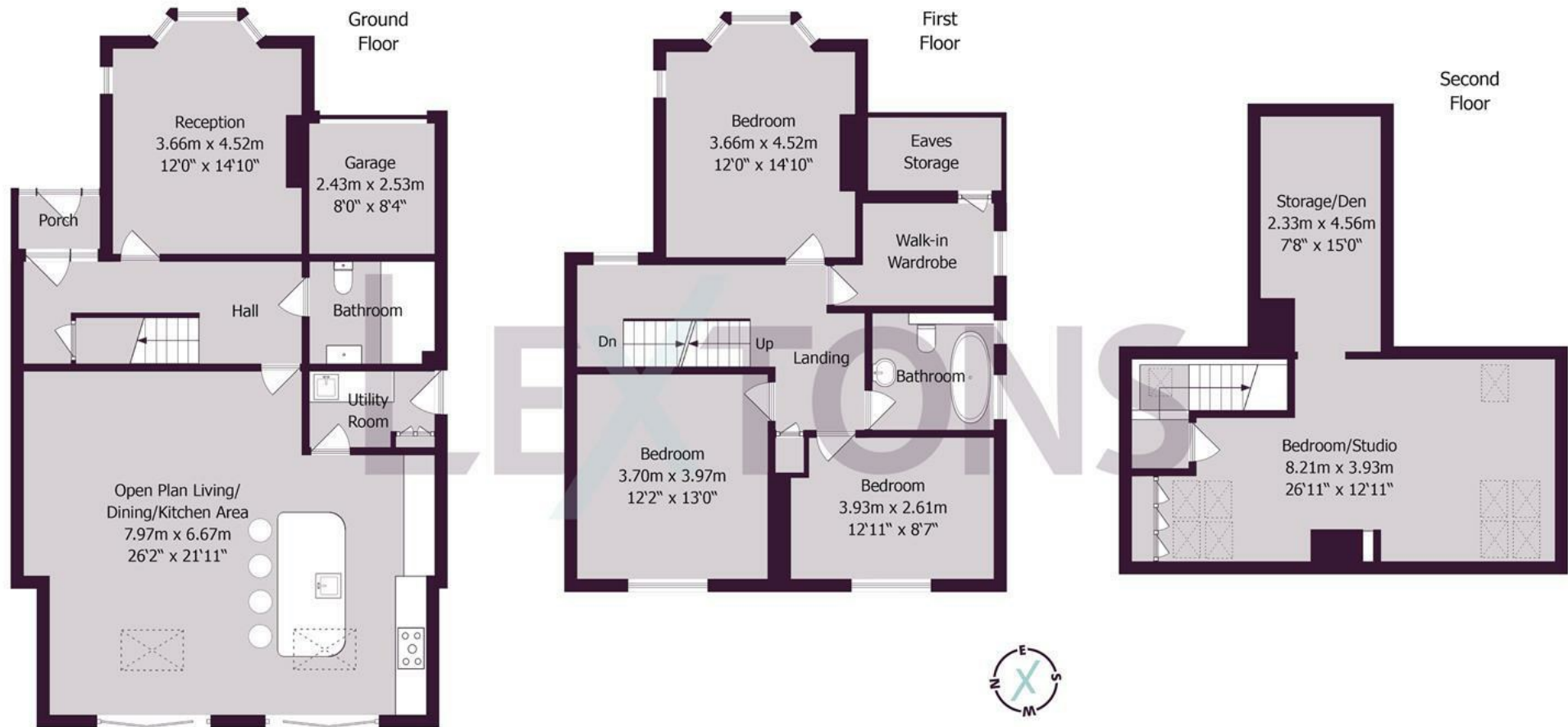

Approximate gross internal floor area 205.4 sq m/ 2211 sq ft

Whilst every care has been taken to ensure accuracy, dimensions are approximate and for illustrative purposes only.

Created by Property Photography UK for Lextons. All rights reserved.

Meet us here...

174 Church Road
Hove
BN3 2DJ

We aim to make our particulars both accurate and reliable. However they are not guaranteed; nor do they form part of an offer or contract. If you require clarification on any points then please contact us, especially if you're traveling some distance to view. Please note that appliances and heating systems have not been tested and therefore no warranties can be given as to their good working order.



LEXTONS

01273 56 77 66